

**ECOSYS MA2100cwf & ECOSYS MA2100cf:**

# A classic, redefined

With the new ECOSYS MA2100cwf & ECOSYS MA2100cf, we have transformed a hugely popular legacy device, making it the perfect fit for the new age of work. This compact and highly reliable A4 multi-function printer combines the best of Kyocera's ECOSYS technology with modern innovation to meet the needs of the most demanding workspaces, be they in the office or across remote locations.

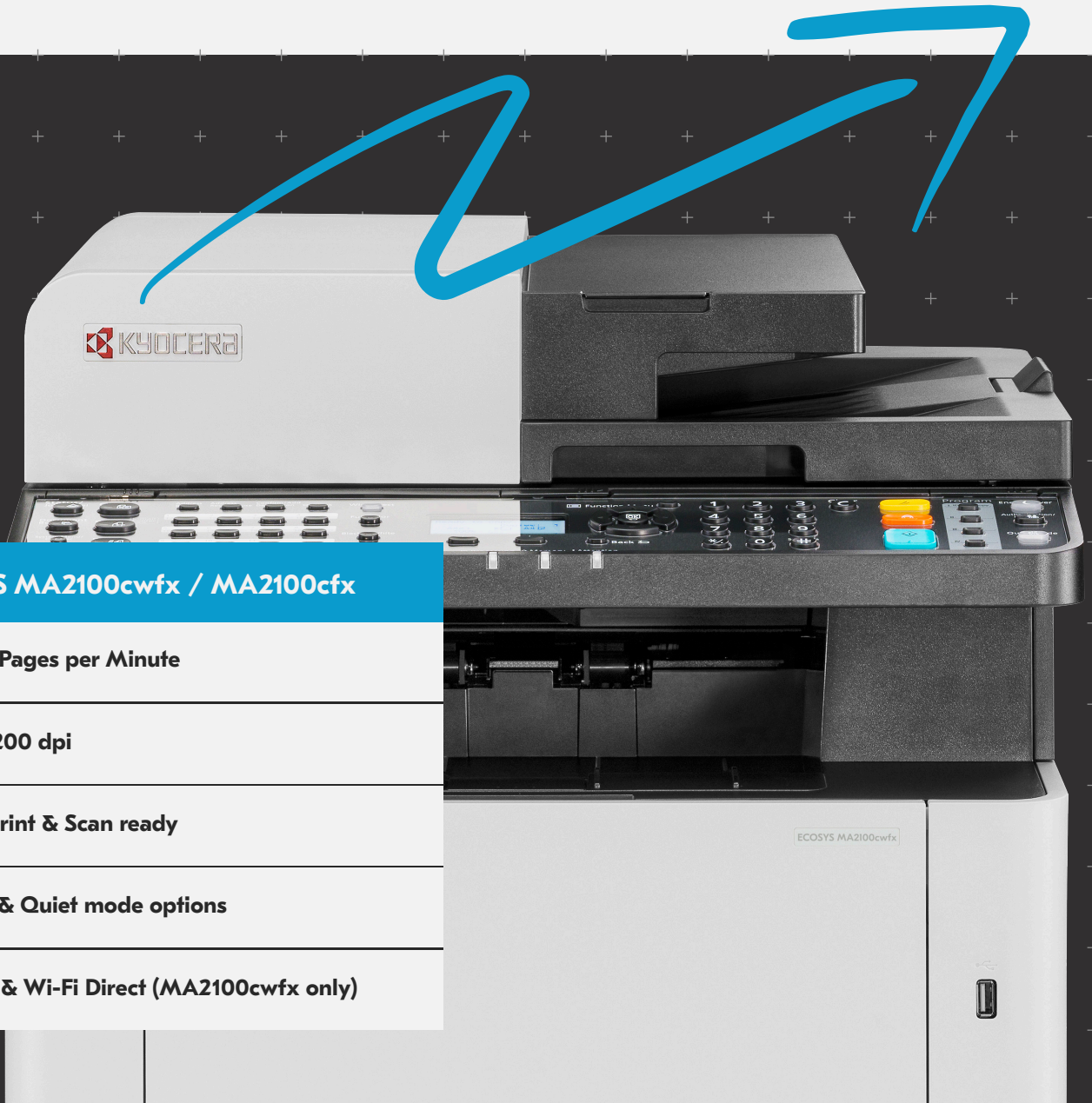

## **ECOSYS MA2100cwf / MA2100cf**

**Up to 21 Pages per Minute**

**1200 x 1200 dpi**

**Mobile Print & Scan ready**

**EcoPrint & Quiet mode options**

**Wireless & Wi-Fi Direct (MA2100cwf only)**

# ECOSYS MA2100cwfxf / MA2100cfx

## GENERAL

**Technology:** KYOCERA ECOSYS, Colour Laser

**Control panel display:** 5 lines LCD display

**Engine speed:** Up to 21 pages A4 per minute in colour and b/w

**Resolution:** 1,200 x 1,200 dpi print at reduced speed, multibit technology for print quality of up to 9,600 x 600 dpi (print), 600 x 600 dpi, 256 greyscales per colour (scan/copy)

**Warm-up time:** Approx. 32 seconds or less

**Time to first print:** Approx. 11/12.5 seconds or less in b/w/colour

**Time to first copy:** Approx. 10/12 seconds or less in b/w/colour

**CPU:** 800MHZ

**Memory:** Standard 512 MB, max. 1,536 MB

**Standard interface:**

ECOSYS MA2100cfx: USB 2.0 (Hi-Speed), USB Host Interface, Gigabit Ethernet (10BaseT/100BaseTX/1000BaseT) Slot for optional SD/SDHC-Card

ECOSYS MA2100cwfxf: USB 2.0 (Hi-Speed), USB Host Interface, Gigabit Ethernet 10BaseT/100BaseTX/1000BaseT), Wireless LAN, Slot for optional SD/SDHC-Card

**Dimensions (W x D x H):** Main unit: 417 x 429 x 495 mm

**Weight:** Main unit: Approx. 26 kg

**Power source:** AC 240 V, 50 Hz

**Power consumption:**

**Copy/Print:** 345 W

**Ready mode:** 41 W

**Sleep mode:** 1 W

**Noise (Sound pressure level: ISO 7779/ISO 9296):**

Copy/Print BW/colour: 48/48 dB(A) LpA

Ready/Standby mode: 30 dB(A) LpA

Sleep mode: Immeasurably low

**Safety standards:** AS/NZS 60950.1/62368.1/IEC 60825.1

This unit is manufactured according to ISO 9001 quality standard and ISO 14001 environmental standard.

## PAPER HANDLING

All paper capacities quoted are based on a paper thickness of max. 0.11 mm. Please use paper recommended by KYOCERA under normal environmental conditions.

**Input capacity:** 50-sheet multi-purpose tray; 60-220 g/m<sup>2</sup> A4, A5, A6, B5, B6, Letter, Legal, Custom (70 x148 mm-216 x356 mm) 250-sheet universal cassette: 60 -163 g/ m<sup>2</sup>

A4, A5, A6, B5, B6, Letter, Legal, Custom (105 x148 - 216 x 356mm). Max. Input capacity with options: 550 sheets

**Duplex functionality as standard:** Double-sided printing:

60 -120 g/m<sup>2</sup>; A4, A5, B5, Letter, Legal

**Document processor:** 50-sheet, 50-160 g/m<sup>2</sup>, A4, A5, A6,

B5, Letter, Legal, Custom (105 x148 mm to 216 x356 mm)

Output capacity: Max. 150 sheets face-down with paper full detection

## PRINT FUNCTIONS

**Controller language:** PRESCRIBE IIc

**Emulations:** PCL 6 (PCL 5c/PCL-XL), PostScript 3 (KPDL 3), PDF Direct Print 1.7. XPS Direct Print

**Operating systems:** All current Windows operating systems, MAC OS X Version 10.8 or higher, Unix, Linux as well as other operating systems on request

**Fonts/barcodes:** 93 scalable fonts for PCL/PostScript, 8 fonts for Windows Vista, 1 bitmap font, 45 barcodes (e.g. EAN8, EAN13, EAN128) with automatic generation of checkmarks as well as support of two-dimensional barcodes PDF-417 under PRESCRIBE (PC and other barcodes available as an option)

## COPY FUNCTIONS

**Max. original size:** A4/Legal

**Continuous copying:** 1-999

**Zoom range:** 25-400 % in 1% steps

**Preset magnification ratios:** 7 Reductions/5 Enlargements

**Exposure mode:** Manual: 9 steps

**Image adjustments:** Text + Photo, Photo, Text, Map, Printed document

**Scan resolution:** 600, 400, 300, 200 dpi (256 greyscales-per colour)

**Features:** Auto Colour Mode, Scan-once-copy-many, electronic sort, 2in1, 4in1, ID-card copy, priority print, program, continuous scan, auto cassette change, copy density control

## SCAN FUNCTIONS

**Functionality:** Scan-to-e-mail (SMTP). Scan-to-FTP (FTP over SSL). Scan-to-SMB, Scan to USB Host, TWAIN scan (USB. network). WSD (WIA) scan (USB. network)

**Scan speed:** 30 ipm (300 dpi, A4, b/w), 23 ipm (300 dpi, A4, colour)

**Max. scan size:** A4, Legal

**Scanning volume:** 830 pages per month

**Original recognition:** Text + Photo, Photo, Text, Light Text, Text (for OCR)

**Scan file formats:** TIFF, PDF, PDF/A, high compression PDF, encrypted PDF, JPEG, XPS

**Compression method:** MMR/IPEG

**Features:** Integrated address book, Active directory support, encrypted data transfer, Blank sheet skip

## FAX FUNCTIONS

**Compatibility:** ITU-T Super G3

**Modem speed:** Max. 33.6 kbps

**Transmission speed:** Less than 3 seconds

**Scanning Reader:** 2 sec./sheet or less

**Address book:** 100 entries

## Scanning density:

**Normal:** 200 x 100 dpi, Fine: 200 x 200 dpi

**Superfine:** 200 x 400 dpi, Ultrafine: 400 x 400 dpi

**Maximum original size:** A4, Legal

**Compression method:** BIG, MMR, MR, MH

**Features:** Network fax, duplex transmission and reception, polling transmission and reception, Scanning volume 830 pages per month

## CONSUMABLES

Average continuous toner yield in accordance with ISO/IEC 19798

**Toner-Kit TK-5444K:** black toner yield 2,800 pages A4

**Toner-Kit TK-5444C, TK-5444M, TK-5444Y:** cyan, magenta, yellow toner yield 2,400 pages A4

**Toner-Kit TK-5434K:** black toner yield 1,250 pages A4

**Toner-Kit TK-5434C, TK-5434M, TK-5434Y:** cyan, magenta, yellow toner yield 1,250 pages A4

**Starter Toner yield:** 1,500 pages A4

## OPTIONS

**PF-5110 Paper feeder:** 250 sheets; 60-163 g/m: A4, A5,

A6, B5, B6, Letter, Legal, Custom (105 x 148 mm-216 x 356 mm)

**Memory upgrade:** MM3-1GB: 1,024 MB , MM3-512MB: 512MB

**UG-33:** ThinPrint support

**USB IC Card Reader + Card Authentication Kit (B):** Support for various authentication keys available

## WARRANTY

2-year onsite warranty as standard. KYOCERA guarantees the drum and developer for 3 years or maximum 100,000 pages (whichever occurs sooner), provided the printer is used and cleaned in accordance with the service instructions.

Up to 4-year on-site warranty extension for printer and options.

Specifications and design are subject to change without notice. TASKalfa, PRESCRIBE, Kyocera Net Manager, Kyocera Net Viewer, Kyocera Device Manager, PDF Direct Print, Command Center RX, and KX Driver are trademarks of The Kyocera Companies. Mac OS and AirPrint are trademarks of Apple, Inc. Mopria is a trademark of Mopria Alliance, Inc. Windows is a trademark of Microsoft, Inc. All other trademarks are the property of their respective owners.



**KYOCERA Document Solutions Australia**

**Ph: 13 59 62**

**www.kyoceradocumentsolutions.com.au**

**KYOCERA Document Solutions New Zealand**

**Ph: 0800 459 623**

**www.kyoceradocumentsolutions.co.nz**



Kyocera Document Solutions does not warrant that any specifications mentioned will be error-free. Specifications are subject to change without notice. Information is correct at time of going to press. All other brand and product names may be registered trademarks or trademarks of their respective holders and are hereby acknowledged.

©2022 KYOCERA Document Solutions Australia & New Zealand