

# Skyrocket your efficiency

This flexible device is an all-in-one solution for medium and large-sized work groups, offering everything from double-sided print to copying, scanning and faxing. Our open solution platform, HyPAS, enables powerful customisations for specific tasks while the Single Pass Duplex scanning feeder ensures problem-free and rapid scanning.

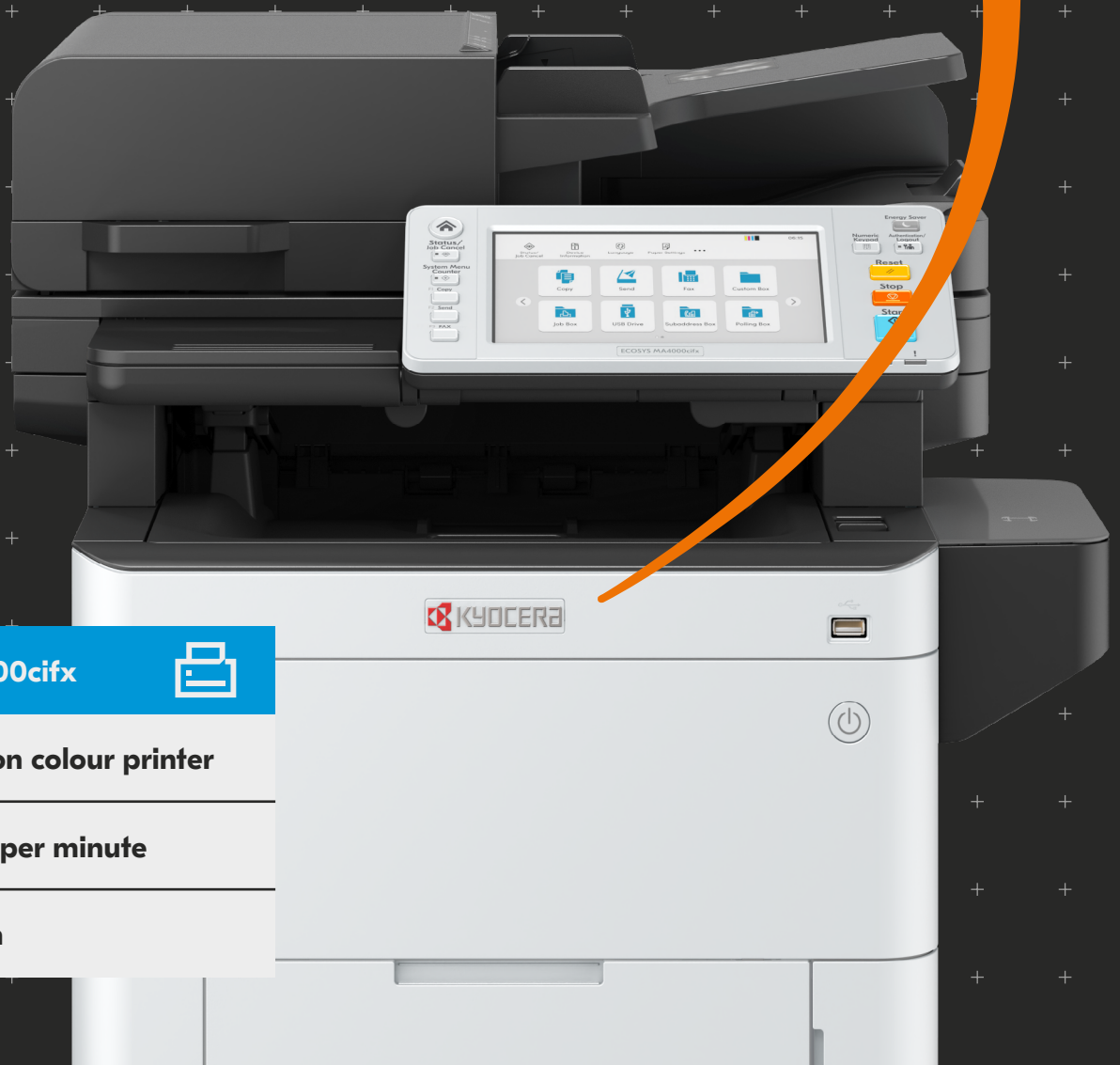

**ECOSYS MA4000cfx**



**A4 multi-function colour printer**

**Up to 40 pages per minute**

**Compact design**

## Specifications

### GENERAL

KYOCERA ECOSYS Laser Colour Multifunctional HyPAS™ solution platform  
**Operation panel:** 177.8 mm (7 inch) full-colour touch panel display, speaker for job notification  
**Type:** Desktop  
**Engine speed:** Up to 40 pages A4 per minute; Duplex print speed: 20 page per minute, A4  
**Duplex copy speed:** 17.5 page per minute, A4  
**Resolution:** 1200 x 1200 dpi (print); 600 x 600 dpi (scan/copy)  
**Recommended Print Volume:** 1,900 images per month.  
**Maximum Print Volume:** 100,000 images per month.  
**Maximum Life:** 600,000 images or 5 years.  
**Scan Volume:** max. 6,000 pages per month.  
**Warm-up time:** Approx. 26 seconds or less.  
**Time to first print:** Approx. 5.4 seconds or less.  
**Time to first copy:** Approx. 6.2 or less (DP); Approx. 5.8 or less (Platen).  
**CPU:** ARM Cortex-A9 Dual core 1.2GHz  
**Memory:** Standard 2GB; Max. 3GB (optional).  
**Standard interfaces:** USB 2.0 (Hi-Speed), 2 x USB Host Interface, Gigabit Ethernet (10BASE-T/100BASE-TX/1000BASE-T), optional Wireless LAN (IEEE 802.11b/g/n), 1 x eKUIO slot for optional devices other than FAX, Slot for optional SD Card  
**Integrated accounting:** 100 department codes  
**Dimensions (W x D x H):** Without packaging: 480 x 577.5 x 571.5 mm (without protrusions); 480 x 577.5 x 575 mm (including protrusions); With packaging: 623 x 728 x 789 mm  
**Weight:** Without packaging: Approx. 39 kg (with bundled toner) Approx. 38 kg (without bundled toner) With packaging: 51 kg  
**Power source:** AC 220 ~ 240 V, 50/60 Hz  
**Power consumption:**  
Printing: 573.6 W  
Copying: 575.0 W  
Ready mode: 18.8 W  
Sleep-mode: 0.5 W  
**Noise (sound pressure level: ISO 7779/ISO 9296):**  
Operating: 53 dB (LpAm)  
Stand-by: 30 dB (LpAm)  
**Safety standards:** TÜV/GS, CE  
This unit is manufactured according to ISO 9001 quality standard and ISO 14001 environmental standard.

### PAPER HANDLING

All paper capacities quoted are based on paper thickness of max. 0.11 mm. Please use paper recommended by KYOCERA under normal environmental conditions.  
**Input capacity:** Multi-purpose tray: 100 sheets (80 g/m<sup>2</sup> equivalent), 110 sheets (64 g/m<sup>2</sup> equivalent). 60–220 g/m<sup>2</sup> A4, A5, A6, B5, B6, Letter, Legal, Folio, Custom (70 x 140 to 216 x 356 mm), Banner paper up to 1220 mm. Standard universal paper cassette: 250 sheet with 75 g/m<sup>2</sup>, 300 sheet with 64 g/m<sup>2</sup>. 60–220 g/m<sup>2</sup>. A4, A5, A6, B5, B6, Letter, Legal, Folio, Custom (105 x 140 to 216 x 356 mm). Max. input capacity with options: 2,050 sheets with 75 g/m<sup>2</sup>; 2,210 sheets with 64 g/m<sup>2</sup>  
**Duplex:** Standard duplex unit, 60–163 g/m<sup>2</sup>, A4, A5, B5, Letter, Legal, Custom (140x 210 mm - 216 x 356 mm).  
**Document Processor:** Dual scan document processor as standard, 100 sheets, 50–120 g/m<sup>2</sup>, A4, A5, A6, B5, Letter, Legal, Custom (105 x 148 to 216 x 356 mm).  
**Output capacity:** 250 sheets (Equivalent to 80 g/m<sup>2</sup>) face down with paper full sensor

### PRINT FUNCTIONS

**Controller language:** PRESCRIBE  
**Emulations:** PCL6 (5c/XL), KPDL3 (PostScript 3 compatible), PDF, XPS, Open XPS, TIFF, JPEG, URF, PWG Raster, PCLm  
**Operating systems:** All current Windows operating systems, MAC OS X Version 10.9 or higher, Chrome OS, Linux, as well as other operating systems on request.  
**Fonts/barcodes:** 93 outline fonts (PCL6, KPDL3), 4 fonts (Calibri), 4 fonts (Cambria), 1 Bitmap font, 45 types of one-dimensional barcodes, 1 type of two-dimensional barcode (PDF417).  
**Print features:** PDF Direct Print, Internet printing IPP 1.0, E-mail printing, WSD print, secure printing IPP over TLS, Local and network authentication, Network data encryption IPsec, HTTPS, LDAP over TLS, SNMPv3, SMTP over TLS, POP over TLS, Encrypted PDF Direct Print, TLS 1.3, Secure Boot, Run-time Integrity Check, Microsoft Universal Print, Printing for Chrome OS  
**Mobile printing support:** KYOCERA Mobile Print app for iOS and Android, AirPrint, Mopria, Microsoft Universal Print, Wi-Fi Direct (Opt).

### COPY FUNCTIONS

**Max. original size:** A4/Legal.  
**Continuous copying:** 1–999.  
**Zoom range:** 25–400% in 1% steps.  
**Preset magnification ratios:** 5 Reductions / 5 Enlargements.  
**Image adjustments:** Text + Photo, Photo, Text, Chart/Map, Printed document.  
**Features:** Electronic sort (collate), ID card copy, 2in1, 4in1, auto cassette change, Skip blank page, Skip Line, DP Auto-cropping

### SCAN FUNCTIONS

**Functionality:** Scan-to-Email, Scan-to-FTP, Scan-to-SMB, Scan to USB Host, Network TWAIN, WIA, WSD scan, Chrome OS (Scan), AirPrint, Mopria.  
**Scan speed Simplex:** 60 ipm (300 dpi, A4, b/w); 50 ipm (300 dpi, A4 colour)  
**Scan speed Duplex:** 120 ipm (300dpi, A4, b/w); 100 ipm (300 dpi, A4, colour)  
**Scan resolution:** 300 dpi x 300 dpi, 200 dpi x 200 dpi (Default), 200 dpi x 100 dpi, 600 dpi x 600 dpi, 400 dpi x 400 dpi, 200 dpi x 400 dpi, 1200dpix1200dpi (TWAIN driver, WIA driver). 256 greyscales per colour  
**Max. scan size:** A4, Legal, Banner paper (max 915mm).  
**Original recognition:** Text, photo, text + photo, light text, optimised for OCR  
**File types:** TIFF (MMR/JPEG compression), JPEG, XPS, Open XPS, PDF (MMR/JPEG compression), PDF/A-1, PDF/A-2, PDF (High compression), Encrypted PDF, MS Office file (Opt), Searchable PDF (Opt)  
**Features:** Banner Scan, Colour scan, integrated address book, Active Directory support, encrypted data transfer, multi send (e-mail, fax, SMB/FTP folder, print) at once, Blank page skip, Border Erase, Digital Signature (Require SSD), DP Auto Crop

### FAX FUNCTIONS

**Compatibility:** Super G3.  
**Modern speed:** Max. 33.6 kbps.  
**Transmission speed:** Max. 3 seconds (JBIG).  
**Scanning speed:** 2.5 seconds or less.  
**Address book:** Personal 200 entries, Group 50 entries  
**Scanning density:**  
Normal: 8 dot/mm x 3.85 line/mm (200 x 100 dpi)  
Fine: 8 dot/mm x 7.7 line/mm (200 x 200 dpi)  
Superfine: 8 dot/mm x 15.4 line/mm (200 x 400 dpi)  
Ultrafine: 16 dot/mm x 15.4 line/mm (400 x 400 dpi)

Halftone: 256 grey scales  
**Original size:** A4, Legal, A6, Banner (max 915mm)  
**Compression method:** JBIG, MMR, MR, MH  
**Memory reception:** 256 sheets or more  
**Features:** Network fax, duplex transmission and reception, encrypted transmission and reception, polling transmission and reception, broadcast.

### CONSUMABLES

Average continuous toner yield in accordance with ISO 19798  
**TK-5380K:** Black 13,000 pages  
**TK-5380Y, TK-5380M, TK-5380C:** Yellow, Magenta and Cyan 10,000 pages A4, Starter toner black 6,000 pages and Yellow, Magenta and Cyan 5,000 pages A4

### OPTIONS

**PF-5150 Paper feeder:** Max. 550 sheet with 75 g/m<sup>2</sup>, 600 sheet with 64 g/m<sup>2</sup>, 60 - 220 g/m<sup>2</sup>, A5R - Legal, 92.1 x 165.1 (Com6), 114x162 (Youkei2), Max 3 Units  
**Memory upgrade:** 1GB/2GB  
**Storage Devices for easy document management:**  
HD-17 SSD hard disk: 64GB  
HD-18 SSD hard disk: 256GB  
HD-19 SSD hard disk: 512GB  
**Scan Extension Kit (A):** Scan to searchable PDF (embedded OCR) or to MS Office (docx, xlsx, pptx), HD or SD card is needed.

### SECURITY

**UG-33:** ThinPrint support  
**UG-35:** TPM (Trusted Platform Module)  
**USB IC Card Reader + Card Authentication Kit (B):** Support for various authentication keys available.  
**Optional interface:**  
**IB-37:** Wireless LAN (802.11a/b/g/n/ac) with Wi-Fi Direct  
**IB-38:** Wireless LAN (802.11b/g/n) with Wi-Fi Direct  
**IB-50:** Gigabit Ethernet 10BASE-T/100BASE-TX/1000BASE-T  
**IB-51:** Wireless LAN Interface (802.11b/g/n)  
Product Library 14: Installation DVD

### WARRANTY

1-year warranty as standard \*\*. KYOCERA guarantees the drum and developer for 3 years or 200,000 pages (whichever occurs sooner), provided each device is used and cleaned in accordance with the service instructions.

### KYOCERA LIFE

Up to 5-year on-site warranty extensions available for product and options.

### WHAT'S IN THE BOX:

Main unit, starter toner, waste toner box, Quick guide, Safety Guide, Operation panel sheet, power supply cord.

\*The device is not designed to achieve the specified volumes in continuous operation. The maximum volumes relate to the use of the print or scan unit and include their use for the printing, copying and scanning functions. Note: In this context, a copied page corresponds to a scanned and a printed page.

ECOSYS stands for ECOlogy, ECONomy and SYStem printing. With their long-life components, ECOSYS devices are designed to maximise durability and minimise the total cost of ownership with regard to maintenance, administration and consumables. The cartridge-free system means that only the toner has to be replaced regularly. The modular design concept allows you to add workflowenhancing functions as required. Integrated system software provides long-term crossnetwork compatibility. KYOCERA's long-life components cost you and the environment less.



KYOCERA Document Solutions Partner

JUN2023MA4000cifix/VER1.0

KYOCERA Document Solutions Europe B.V.  
Bloemlaan 4, 2132 NP Hoofddorp, The Netherlands  
Tel +31 (0) 20-654-0000 – Fax +31 (0) 20-653-1256  
www.kyoceradocumentsolutions.eu – info@deu.kyocera.com



\* KYOCERA Document Solutions does not warrant that any specifications mentioned will be error-free. Specifications are subject to change without notice. Information is correct at time of going to press. All other brand and product names may be registered trademarks or trademarks of their respective holders and are hereby acknowledged.  
\*\* Depending on the country